

First Impressions OGN150SMTSBR

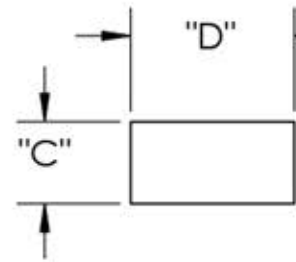
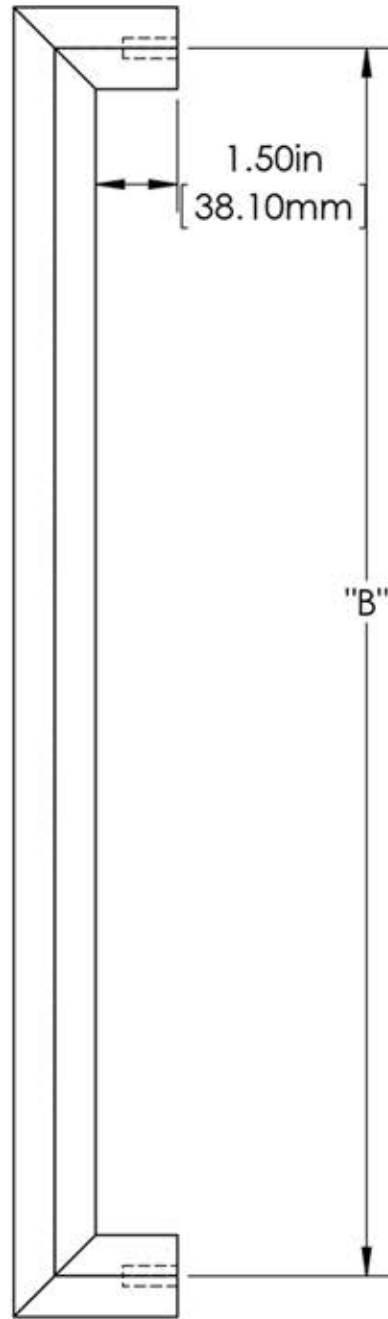
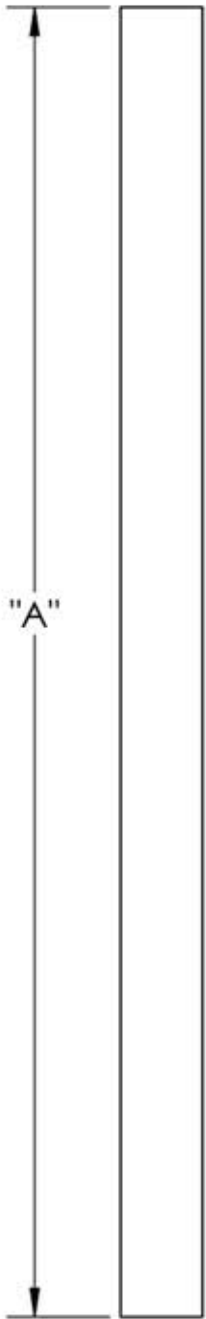

Overall Length "A"	Center To Center "B"	Dimension "C" x "D"
18"(457mm)	17"(432mm)	1 1/2" x 2"(38mm x 51mm)
24"(610mm)	23"(584mm)	1 1/2" x 2"(38mm x 51mm)
36"(914mm)	35"(889mm)	1 1/2" x 2"(38mm x 51mm)